

## Item# SML227262-3000K-GD Chandelier

Fixture Dimension: D24"(61cm) xH144" (366cm)

Wire: 12ft. (366 CM)

Fixture Color: Gold

Fixture Weight: 38 Lbs. (17.2 Kg)

Bulbs: Integrated LED – Kelvin: 3000K – Lumen: 2900- Dimmable

Wattage:73W

Voltage: 110-120V~ 50/60Hz

Approved Location: Dry Location

### Compatible Dimmers:

Lutron Maestro 60-Watt Single-Pole/3-Way MultiLocation Digital CFL-LED Dimmer

Lutron Maestro 60-Watt Multi-Location Digital CFL-LED Dimmer Kit - White

Lutron RadioRA RA-600L Dimmer Switch Radio RA - Almond

Lutron RadioRA RALV-600L Single Pole Dimmer Switch Radio RA - Light Almond LA

Leviton 6343-Wi Decora Single Or 3 Way X10 Dimmer Switch X-10 2

Leviton MicroDim Remote 17775

Leviton DZS15-1LZ Decora Z-Wave Controls 15-Amp Scene Capable Switch, White

Leviton VP00R-1LZ, Vizia + Digital Matching Remote Dimmer/Fan Speed Control, New



Assembly Instructions for

## Item# SML227262-3000K-GD

**ATTENTION:**

CONSULT A QUALIFIED ELECTRICIAN TO ENSURE CORRECT BRANCH CIRCUIT CONDUCTOR.  
SHUT OFF POWER SUPPLY AT FUSE OR CIRCUIT BREAKER.  
USE ONLY THE SPECIFIED BULBS AND DO NOT EXCEED THE MAXIMUM WATTAGE.

**BEFORE YOU INSTALL:**

1. Check the fixture frame for any physical damage
2. Check all parts and crystals to ensure they are not damaged or missing
3. Test all sockets with a bulb for conductivity before "dressing" the fixture
4. If there is any problem, please do not install the fixture, please contact the vendor and solve the problem first.

### Outlet Box

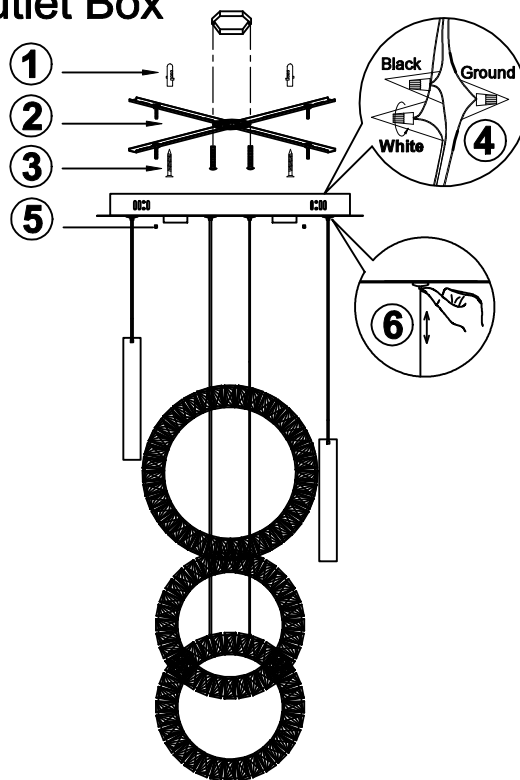

**INSTALLATION STEPS:**

1. For mounting into plaster - use the Rawl plugs ( 1 ) provided
2. Screw the cross bar ( 2 ) into the ceiling using the screws ( 3 ) as shown
3. Connect the junction box ( 4 ) to the cross bar, connect the wire correctly, L(black), N(white), E
4. Fix the junction box lid into place and lock bolt ( 5 ) to secure the fixture on the crossbar
5. Adjust the hanging height, push in the sleeve ( 6 ) then push up or push down the hanging wire to adjust

You have completed the installation for this fixture, enjoy it please.